

## LUGS AND CONNECTORS

## Copper Crimp Lug

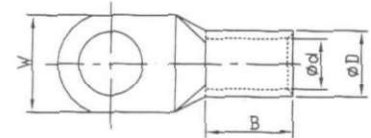

- The lugs are made from high conductivity annealed copper which gives the best electrical properties possible.
- Material: copper-99.9% pure.
- Operating Temperature: -55°C to 155°C due to oxygen-free copper  
Surface: Tin plating.

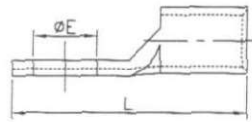

Item No.	Dimensions(mm)				
	ΦE	Φd	W	B	L
SC1.5-4	4.2	1.8	8.0	5.0	16.0
SC1.5-5	5.2	1.8	10.0	5.0	17.0
SC1.5-6	6.5	1.8	10.0	5.0	18.0
SC2.5-4	4.2	2.4	8.0	7.0	18.0
SC2.5-5	5.2	2.4	10.0	7.0	20.0
SC2.5-6	6.5	2.4	10.0	7.0	20.0
SC2.5-8	8.4	2.4	12.0	7.0	23.0
SC4-4	4.2	3.1	10.0	7.0	20.0
SC4-5	5.2	3.1	10.0	7.0	20.0
SC4-6	6.5	3.1	10.0	7.0	20.0
SC4-8	8.4	3.1	12.5	7.0	23.0
SC6-4	4.2	3.8	10.0	9.0	24.0
SC6-5	5.2	3.8	10.0	9.0	24.0
SC6-6	6.5	3.8	12.0	9.0	24.0
SC6-8	8.4	3.8	12.5	9.0	26.0
SC6-10	10.5	4.0	15.0	9.0	26.0
SC10-5	4.2	4.5	12.0	9.0	25.0
SC10-6	5.2	4.5	12.0	9.0	25.0
SC10-8	6.5	4.5	12.5	9.0	27.0
SC10-10	8.4	4.5	15.0	9.0	27.0
SC10-12	10.5	4.5	17.0	9.0	27.0
SC16-5	5.2	5.4	12.0	12.0	30.0
SC16-6	6.5	5.4	12.0	12.0	30.0
SC16-8	8.4	5.4	12.5	12.0	30.0
SC16-10	10.5	5.4	16.0	12.0	33.0
SC16-12	13.0	5.4	17.0	12.0	33.0
SC25-5	5.2	6.8	13.0	12.0	35.0
SC25-6	6.5	6.8	13.0	12.0	35.0
SC25-8	8.4	6.8	15.0	12.0	35.0

Item No.	Dimensions(mm)				
	ΦE	Φd	W	B	L
SC25-10	10.5	6.8	18.0	12.0	35.0
SC25-12	13.0	6.8	18.0	12.0	35.0
SC25-14	15.0	6.8	20.0	12.0	35.0
SC35-5	5.2	8.2	16.0	14.0	38.0
SC35-6	6.5	8.2	16.0	14.0	38.0
SC35-8	8.4	8.2	16.0	14.0	38.0
SC35-10	10.5	8.2	18.0	14.0	39.0
SC35-12	13.0	8.2	19.0	14.0	40.5
SC35-14	15.0	8.2	20.0	14.0	45.0
SC50-6	6.5	9.5	17.8	16.0	45.0
SC50-8	8.4	9.5	17.8	16.0	45.0
SC50-10	10.5	9.5	17.8	16.0	45.0
SC50-12	13.0	9.5	20.0	16.0	45.0
SC50-14	15.0	9.5	22.0	16.0	46.0
SC50-16	17.0	9.5	24.0	16.0	46.0
SC70-8	8.4	11.2	21.0	20.0	49.0
SC70-10	10.5	11.2	21.0	20.0	49.0
SC70-12	13.0	11.2	21.0	20.0	49.0
SC70-14	15.0	11.2	21.0	20.0	49.0
SC70-16	17.0	11.2	25.0	20.0	49.0
SC95-8	8.4	13.5	25.0	23.0	55.0
SC95-10	10.5	13.5	25.0	23.0	55.0
SC95-12	13.0	13.5	25.0	23.0	55.0
SC95-14	15.0	13.5	25.0	23.0	55.0
SC95-16	17.0	13.5	25.0	23.0	55.0
SC120-8	8.4	15.0	27.5	22.0	60.0
SC120-10	10.5	15.0	27.5	22.0	60.0
SC120-12	13.0	15.0	27.5	22.0	60.0
SC120-14	15.0	15.0	27.5	22.0	60.0

# LUGS AND CONNECTORS

Item No.	Dimensions(mm)				
	ΦE	Φd	W	B	L
SC120-16	17.0	15.0	27.5	22.0	63.0
SC120-20	21.0	15.0	27.5	22.0	63.0
SC150-8	8.4	16.5	30.0	26.0	70.0
SC150-10	10.5	16.5	30.0	26.0	70.0
SC150-12	13.0	18.5	30.0	26.0	70.0
SC150-14	15.0	16.5	30.0	26.0	70.0
SC150-16	17.0	16.5	30.0	26.0	70.0
SC150-20	21.0	16.5	30.0	26.0	70.0
SC185-10	10.5	18.5	33.5	32.0	75.0
SC185-12	13.0	18.5	33.5	32.0	75.0
SC185-14	15.0	18.5	33.5	32.0	75.0
SC185-16	17.0	18.5	33.5	32.0	75.0
SC185-20	21.0	18.5	33.5	32.0	75.0
SC240-10	10.5	21.0	38.0	38.0	90.0
S240-12	13.0	21.0	38.0	38.0	90.0
SC240-14	15.0	21.0	38.0	38.0	90.0
SC240-16	17.0	21.0	38.0	38.0	90.0
SC240-20	21.0	21.0	38.0	38.0	90.0
SC300-10	10.5	23.5	43.0	42.0	98.0
SC300-12	13.0	23.5	43.0	42.0	98.0
SC300-14	15.0	23.5	43.0	42.0	98.0
SC300-16	17.0	23.5	43.0	42.0	98.0
SC300-20	21.0	23.5	43.0	42.0	98.0
SC400-10	10.5	28.5	52.0	44.0	114.0
SC400-12	13.0	28.5	52.0	44.0	114.0
SC400-14	15.0	28.5	52.0	44.0	114.0
SC400-16	17.0	28.5	52.0	44.0	114.0
SC400-20	21.0	28.5	52.0	44.0	110.0
SC500-10	10.5	30.0	55.0	48.0	120.0
SC500-12	13.0	30.0	55.0	48.0	120.0
SC500-14	15.0	30.0	55.0	48.0	120.0
SC500-16	17.0	30.0	55.0	48.0	120.0
SC500-20	21.0	30.0	55.0	48.0	120.0
SC630-10	10.5	35.0	63.5	56.0	140.0
SC630-12	13.0	35.0	63.5	56.0	140.0
SC630-14	15.0	35.0	63.5	56.0	140.0
SC630-16	17.0	35.0	63.5	56.0	140.0
SC630-20	21.0	35.0	63.5	56.0	140.0